

# HSIIDC I.E. PANIPAT REVISED LAYOUT PLAN

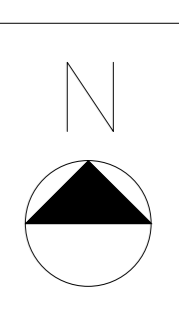

## AREA STATEMENT

S.no.	SCHEDULE OF AREA	ACRES
1	TOTAL AREA	922.97
2	AREA TO BE PLANNED LATER	89.71
3	NET AREA PLANNED	833.26
4	AREA UNDER INDUSTRIAL PLOTS	426.98
5	AREA UNDER R&R RESIDENTIAL PLOTS	26.00
6	AREA UNDER COMMERCIAL & CONVENIENT SHOPPING COMPLEX	10.70
7	AREA RESERVED FOR PUBLIC UTILITIES	40.89
8	AREA UNDER GROUP HOUSING SITES	14.04
9	AREA UNDER HSIIDC OFFICE	1.56
10	AREA UNDER SCHOOLS/ CRECHE	3.98
11	AREA UNDER STAFF RESIDENCE	2.17
12	AREA UNDER CLUB	1.46
13	AREA UNDER FIRE STATION	1.28
14	AREA UNDER POLICE STATION	1.37
15	AREA UNDER DISPENSARY	2.37
16	AREA UNDER 132KV SUB STATION	4.44
17	AREA UNDER ROADS, GREEN BELTS AND OPEN SPACES ETC.	296.02

## DETAIL OF PLOTS (GENERAL INDUSTRY)

S.NO.	AREA IN ACRES	SIZE IN METERS	NO'S
1	70 AC.	---	01
2	19.3 AC.	---	01
3	16.4 AC.	---	01
4	16.0 AC.	---	01
5	14.1 AC.	---	01
6	10.0 AC.	120 x 330	04
7	8.2 AC.	---	01
8	6.0 AC.	---	01
9	5 AC.	90 x 210	01
10	2.55 AC.	---	01
11	2 AC.	75 x 105	41
12	1.77 AC.	---	01
13	1.68 AC.	65 x 105	04
14	1 AC.	45 x 90	68
15	0.89 AC.	40 x 90	02
16	0.76 AC.	34 X 90	01
17	0.68 AC.	---	01
18	0.52 AC.	30 X 70	05
19	0.44 AC.	30 x 60	64
20	0.25 AC.	22.5 x 45	94
21	0.15 AC.	20 x 30	02
22	0.11 AC.	15 x 30	140
TOTAL			436

## DETAIL OF GROUP HOUSING PLOTS

S.NO.	AREA IN ACRES	SIZE IN METERS	NO'S
1	0.74 AC	---	01
2	0.49 AC.	40M X 50M	27
TOTAL			28

## DETAIL OF RESIDENTIAL PLOTS ( R & R POLICY)

S.NO.	CATEGORY	SIZE	TOTAL NO. OF PLOTS
1	14 MARLA	14m x 25m	197
2	10 MARLA	12m x 21m	68
3	8 MARLA	10m x 20m	30
4	6 MARLA	8.5m x 18m	54
5	4 MARLA	7m x 14m	22
6	3 MARLA	6m x 12.5m	36
TOTAL			407

NOTE:  
\* THIS DRAWING SUPERCEDES DRG NO. HSIIDC/IPD/1386, DATED :- 12/10/2021.

DRG. NO. HSIIDC/IPD/1461, DATED :- 21.09.2022.

DRAWN BY:- GAURAV(-SD-)

P.O.-: SURENDER M. PRASHAR(-SD-)

A.T.P.-: POOJA RANI (-SD-)

D.T.P.-: ANINDERBIR KAUR (-SD-)

S.T.P.-: USHA KIRAN (-SD-)

C.T.P.-: DINESH SINGH CHAUHAN (-SD-)

DIRECTOR CONTROLLED AREA CUM M.D. HSIIDC:-

VIKAS GUPTA (-SD-)

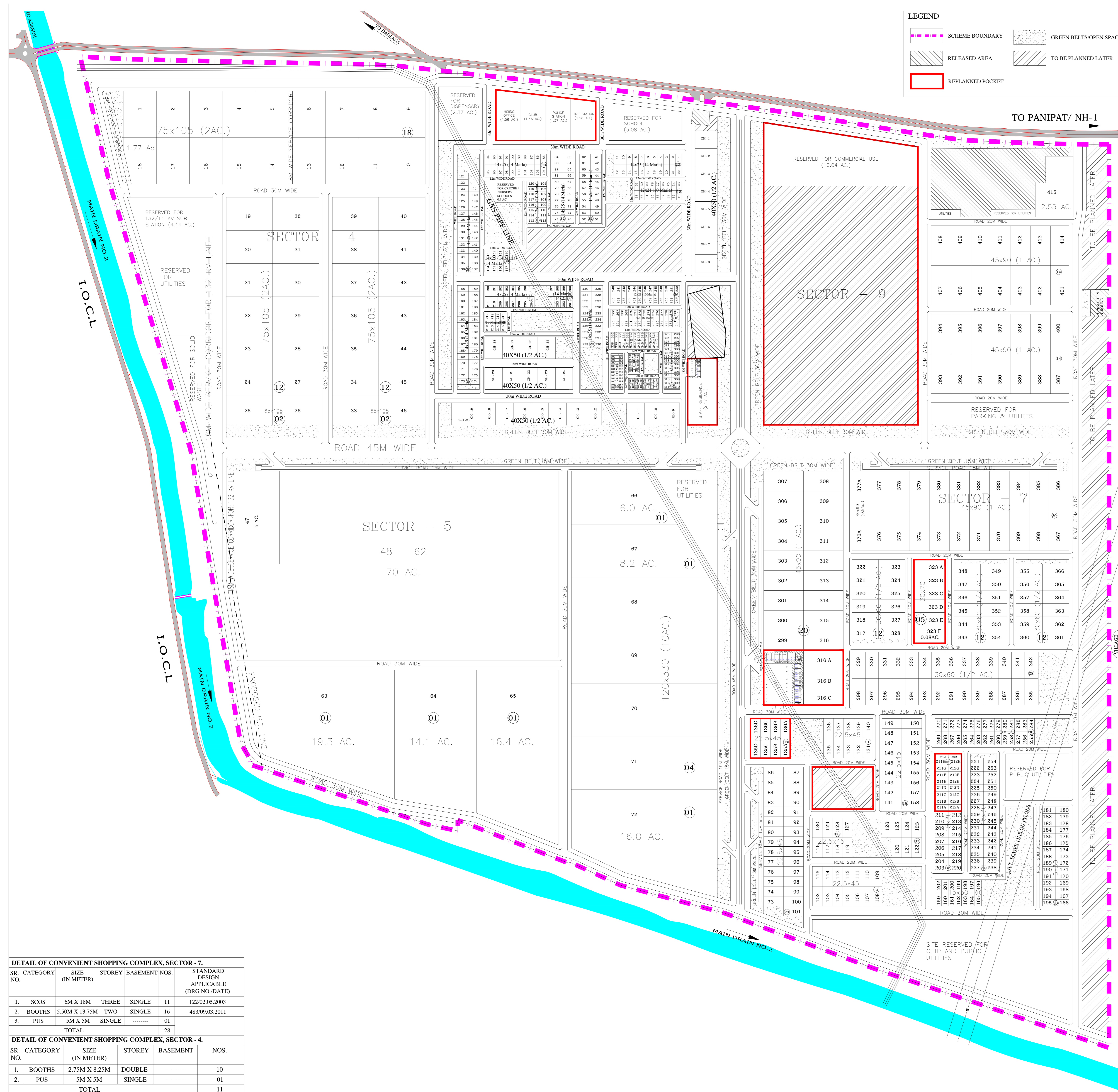

SR. NO.	CATEGORY	SIZE (IN METER)	STOREY	BASEMENT	NOS.	STANDARD DESIGN APPLICABLE (DRG NO./DATE)
1.	SCOS	6M X 18M	THREE	SINGLE	11	122/02.05.2003
2.	BOOTH	5.50M X 13.75M	TWO	SINGLE	16	483/09.03.2011
3.	PUS	5M X 5M	SINGLE	-----	01	
TOTAL						28

SR. NO.	CATEGORY	SIZE (IN METER)	STOREY	BASEMENT	NOS.	
1.	BOOTH	2.75M X 8.25M	DOUBLE	-----	10	
2.	PUS	5M X 5M	SINGLE	-----	01	
TOTAL						11